

GOVERNMENT OF MEGHALAYA
OFFICE OF THE COMMISSIONER OF TAXES, ETC.,
MEGHALAYA, SHILLONG.

Short Notice Inviting Quotation.

Dated Shillong, the November, 2022.

No.CTA-41/2020/ / Sealed quotation affixing non-refundable court fee stamp of Rs. 25/- (Rupees twenty five) only are invited from the interested firm for supply and installation of LAN Connectivity in the office of the Commissioner of Taxes and Office of the Superintendent of Taxes, Shillong The quotations in two envelopes (1) Technical Bid and (2) Financial Bid along with all the required documents must reach the office of the undersigned on or before **20th December, 2022**. The quotation (technical bid) will be opened at **3:00 P.M.** on the same day in presence of the quotationer(s) or their authorized representative(s) if any.

Detailed requirement, specifications and other terms & conditions are available on the Department website meggst.gov.in or may be had from the office of the Commissioner of Taxes, Lower Lachumiere, Shillong on any working days during office hours before the 19.12.2022.

(Sibhi Chakravarthy Sadhu, IAS)
Commissioner of Taxes, etc.,
Meghalaya, Shillong.

Memo No.CTA-44/2020/

Dated Shillong, the November, 2022

Copy to :-

- 1) The Director, Information & Public Relation, Meghalaya, Shillong for information with a request to publish this NIQ in local & English Daily.
- 2) The Deputy Director General & SIO, NIC, Meghalaya for favour of information.
- 3) The Under Secretary to the Government of Meghalaya, ERTS Department for information.
- 4) Programme Assistant. She is requested to upload this quotation notice in the website of the Department.
- 5) Office Notice Board.

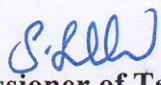
Commissioner of Taxes, etc.,
Meghalaya, Shillong

Terms & Conditions

1. Quotation must be in sealed envelope superscribed " QUOTATION FOR SUPPLY AND INSTALLATION OF LAN CONNECTIVITY along with a forwarding letter under the letter head of the firm duly signed by the Proprietor or their authorized representative(s).
2. Quotation must be submitted into 2(two) parts : (1) Technical Bid and (2) Financial Bid.
3. The Firm(s) should be registered with Government of Meghalaya/Central Government.
4. Rates must be quoted per Unit as per the specified items. Taxes shall be charged extra as applicable.
5. Firm(s) should submit the valid documents like GST registration, professional Tax Certificate, Trading license in case of non-tribal along with the quotation.
6. No overwriting or cutting is permitted in the quoted rate. If found, the quotation shall be summarily rejected. However, except rate, all cuttings and over writing must be signed by the proprietor or the authorized person of the firm. The rates quoted should remain valid for a period of 6(six) months.
7. The supply shall be awarded to the selected firm subject to the approval of the Government.
8. The supply and installation of the materials should be completed within 21(twenty one) days after the issue of supply order.
9. The Commissioner of Taxes, Meghalaya, Shillong reserve the right to reject any quotation in part or the whole of it including cancelling the tender process without assigning any reason thereof. Decision of the Commissioner of Taxes, Meghalaya, Shillong will be final in this regard.
10. Any dispute in the matter shall be confined to the jurisdiction of the Courts at Shillong.

(Sibhi Chaakravarthy Sadhu, IAS)
Commissioner of Taxes,
Meghalaya, Shillong.

List of items, specification and quantity for supply and installation of Local Area Network in the office of the Commissioner of Taxes and the Office of the Superintendent of Taxes, Shillong.

(A) Supply (Active Components)

SI No	Items Description	Unit	Qty	Rate	Amount	Remarks
1	Cisco C1000-24 Port -4G-L,10/ 100/ 1000. 1 X 4 G SFP up-link interface, with installation / configuration and 1year warranty	Nos	4			
Total						

(B) SUPPLY (Passive Component) (UTP) For LAN

SI No	Items Description	Unit	Qty	Rate	Amount	Remarks
1	12U Rack	Nos	2			
2	Wire Manager (CAT6A)	Nos	2			
3	24 Port, Cat 6 Jack Panel (Loaded with UTP I/O)	Nos	2			
4	Cat 6 Cable (305mtr per box)	Nos	4			
5	I/O Box (Single SMB)	Nos	32			
6	UTP Patch Cord-1mtr (CAT6)	Nos	40			
7	UTP Patch Cord-5mtr (CAT6)	Nos	40			
8	Supply of marked PVC duct of size (Per Meter) 45X25 mm	Nos	940			
9	Label for Jack panel/face Plate/Patch Cords (set of 100)	Nos	1			
Total						

(C) INSTALLATION (Passive Component) (UTP) For LAN

SI No	Items Description	Unit	Qty	Rate	Amount	Remarks
1	Installation of 12U Rack	Nos	2			
2	Installation of Wire Manager	Nos	2			
3	Installation of Patch Panel	Nos	2			
4	Installation of marked PVC duct of size (Per Meter) 45X25 mm	Nos	940			
5	In-Building Laying CAT6 UTP cable (per mtr)	Nos	940			
	Termination of Cat6/Cat 6A UTP /FTP /SFTP/STP/FFTP Information Outlet(Both End)	Nos	32			
6.	Installation of Face plate with the SMB Box	Nos	32			
	Labeling & dressing of Cat6/Cat 6A UTP Patch Cords	Nos	32			
7.	Testing, certification & documentation of Cat 6 Nodes(Penta-scanner reports and documentation)	Nos	32			
Total						

(D) SUPPLY (HARDWARE) (UPS)

SI No	Items Description	Unit	Qty	Rate	Amount	Remarks
1	Online UPS 1-KVA with 1 year warranty	Nos	2			
Total						
Grand total (A+B+C+D)						

LAN LAYOUT PLAN - COMMISSIONER OF TAX & SUPERINTENDENT OF TAX 4th Secretariat, East Khasi Hills, Shillong - 793001, Meghalaya.

SUPERINTENDENT OF TAX (THIRD FLOOR)

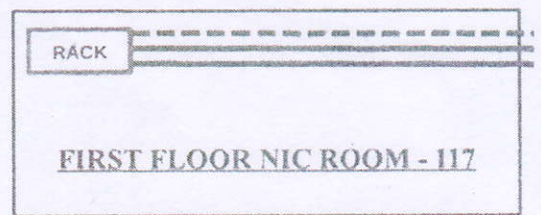
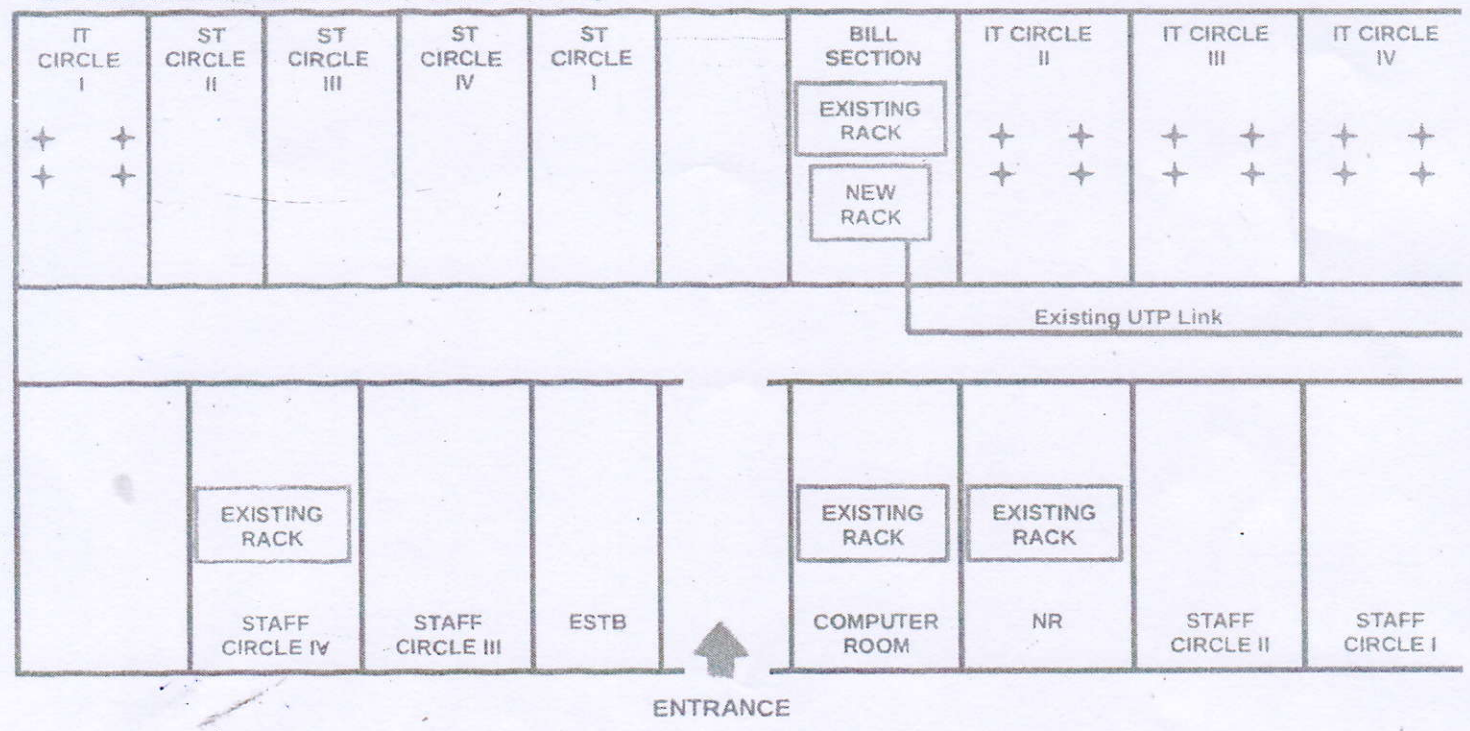

COMMISSIONER OF TAX (SECOND FLOOR)

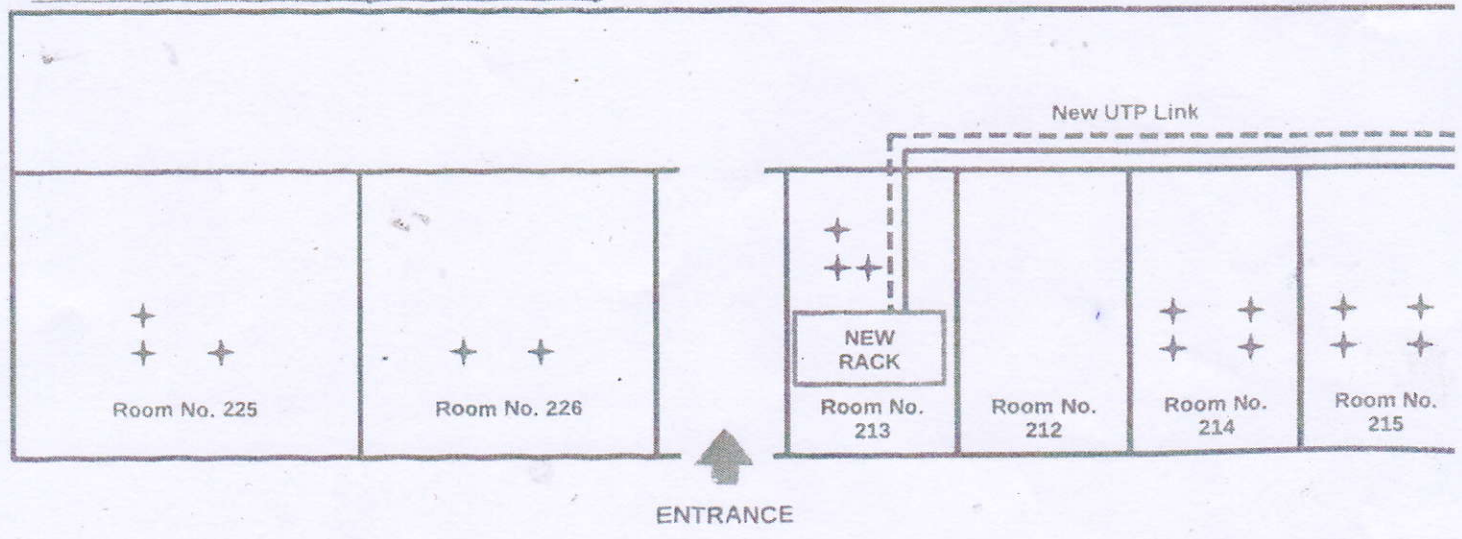

INDEX